

户外降温创新者
Outdoor Cooling Innovator



WT-4C



DW-6C



J-18P

A-4P

A-4C

D-6C



户外降温
整体解决方案提供商
Outdoor Cooling Total Solution Supplier

Company Profile

- **Established Year:** Since 1996
- **Location:** Foshan, Guangdong, China
- **Employees:** About 1300 employees
- **Area:** About 115, 000 m²
(Including 65, 000 m² standard workshop)



- **Honors:**



China's Well-known Trademark

Canton Fair Senior Partner

Canton Fair Official Designated Product

China's Top 10 Brand of Fan Quality

- **Core Philosophy:**

Pursuit of Excellent Quality with Great Efforts



- **Functions:**

Decrease the temperature by 3~8 °C in the effective area
Increase relative humidity, reduce dust and purify air

- **Applications:**

Outdoor occasions like open-air restaurant & cafe, walking street, theme park, garden, bus station and etc.

- **Misting Types:**



Centrifugal Type:

Water flows through the high-speed rotating centrifugal disc. By high-speed hitting on the disc, it turns into mist, then being sprayed out by the blowing system.

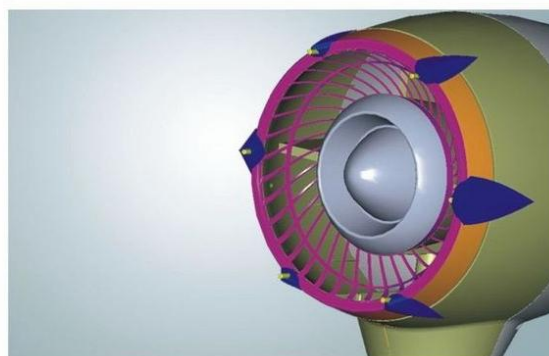

Pressure Type:

After pressed by high pressure pump, water goes through micro nozzles and turns to mist, which are sprayed out by the blowing system to the target area. Mist diameter is ranging from 10-25 microns by using different size of nozzles.

Technical Data

Model	Power (kW)	Volume (m³/h)	Noise dB(A)	Effective Area(m²)	Water Capacity (L)	Water Consumption (L/h)	Fan Size (mm)			N.W. (KG)
							L	W	H	
J-18P	0.13	2100	≤60	45	23	5	520	460	1750	18.5
A-4C	0.32	2450	≤67	95	94	7-10	700	700	2000	59.5
A-4P	0.43	2450	≤69	95	94	12	700	700	2000	64
WT-4C	0.32	2450	≤67	112	6 (automatic inflow)	7-10	470	635	1166	30
D-6C	0.31	15000	≤67	80	60	8-10	670	750	1880	48
D-6P	0.33	15000	≤65	80	60	12	670	750	1880	47.8
DW-6C	0.31	15000	≤67	80	6 (automatic inflow)	8-10	670	586	1065	25.4

Note: C--Centrifugal Type; P-- Pressure Type

Voltage/Frequency(V/Hz): Different choices available



J-18P is POPULA FAN's latest model, which is the innovation of outdoor cooling products. It comes with the thinnest fan head of 150mm, light weight of 18.5KG and low power of 130W. The innovative, fashionable, simple and unique design are sure to bring you modern high-tech feelings.



Fan Head

- The thinnest one of its kind in the global (only 150mm)
- ABS Plastic
- Stable structure



Blowing Motor-24V

- The first one who uses brushless DC motor for misting fan
- Energy-saving
- Safe, low temperature rise

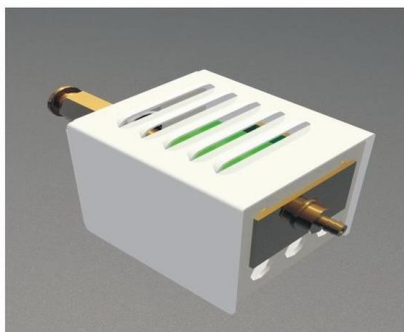

Middle Pressure Pump

- Imported electromagnetic pump
- No oil needed
- Stable pressure
- Easy exchanging
- Low maintenance
- Water shortage protection



Electric box

- IP 44
- Safe
- Electricity and water separated



Nozzle

- High density & stainless net
- Good misting effect
- Easy cleaning
- Recycling use



Pressure Pipe

- Food grade nylon material
- High flexibility
- Strong durability



Oscillating Motor

- High torque
- Synchronous
- Low temperature rise
- Oscillating degree: 90



Water Tank-ABS

- Anti-corrosion, anti-UV & anti-aging
- Capacity: 23L
- Easy cleaning
- Strong PE base
- Convenient mobility



Remote control

- Ultra thin
- Humanized design
- 10 meter infrared remote control
- Multi-functions: 8 speeds, super strong wind, misting, timing, Intermittent misting, oscillating.



A series is one of POPULA FAN's patented products. The unique cone-shaped design makes it possible to hide its motors, wires and pipes, which looks more aesthetically pleasing and high-end. Furthermore, this type of product not only provides excellent performance, but also decorates your hot summer.

Models



A-4C

- Centrifugal Type
- Movable
- Easy maintenance



A-4P

- Pressure Type
- Movable
- Small mist particles
- More mist volume



WT-4C

- Centrifugal Type
- Wall mounted
- Smaller size

Components

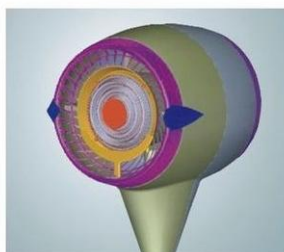

Fan Head

- Stable Structure
- Design Inspiration:
Shape of aero-engine
- Concentrated air flow



Blade

- Aluminum
- balance tested
- Little vibration
- Adjustable blade angle

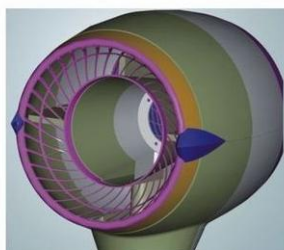

Air Deflector

- Low noise
- Small wind-resistance
- Enhances Air circulation
- Guides air flow direction



Guard Net

- Extends fan life
- Ensures fan stability
- Reduces Fan vibration
- Four colors available:





Based on the technic of A Series, **D Series** is designed to meet the clients' demands of bigger blade, larger air volume and easier maintenance. Therefore, it would be the perfect choice for cooling in open-air bars, restaurants, barbecue site or private garden.

Models



D-6C

- Centrifugal Type
- Movable
- Large air volume
- Easy maintenance



D-6P

- Pressure Type
- Movable
- Large air volume
- Small mist particles



DW-6C

- Centrifugal Type
- Wall mounted
- Large air volume
- Suitable for industrial use



Canton Fair



International Golf Tournament (India)



Dongfang Plaza (China)



Restaurant (Turkey)



Rugby Match (Australia)



佛山市南海九洲普惠风机有限公司 POPULA FAN CO., LTD



地址: 广东省佛山市南海区狮山新城工业区 邮编(Zip): 528222
 Add: Xincheng Industrial Zone, Shishan, Nanhai, Foshan, Guangdong, China
 电话(Tel): +86-757-86630263 传真(Fax): +86-757-86636689
 网址(Website): www.populafan.com.cn www.populafan.com
 邮箱(E-mail): Jessica: ib8@populafan.com (Asia/North America/Africa)
 Cyrus: ib9@populafan.com (Europe/South America/Oceania)

